

GTM L

Art.-No.: 0510051

Abstract

Gas transfer module with 2,900 cm² inner surface area.

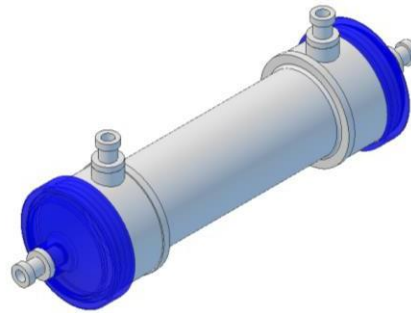
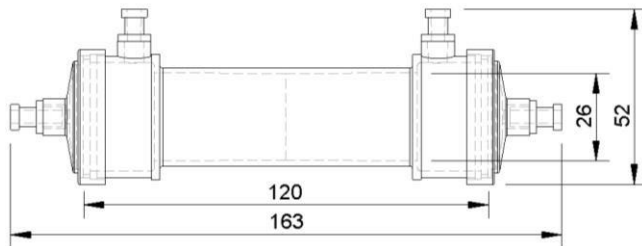

Membrane

Membrane material:

PMP-2, Polymethylpentene

Geometry (ID/OD):

180 µm/ 260 µm

Housing

Housing material:

Polycarbonate

Dimensions:

see drawing

ICS connectors:

2 x Female Luer Connectors (Polycarbonate)

ECS connectors:

2 x Female Luer Connectors (Polycarbonate)

Potting material:

Polyurethane

Module

Number of fibers:

5,200 ± 150

Package density:

~ 50 %

Active fiber length:

100 ± 3 mm

Inner surface area:

2,900 ± 150 cm²

Outer surface area:

4,200 ± 200 cm²

Intra capillary volume:

~ 15.8 ml

Extra capillary volume:

~ 26.6 ml

Max. operating pressure:

1.5 bar

Miscellaneous

Quality control:

100 % Integrity tested (housing + fiber)

Packaging:

single side sealed bag, double bagged

Sterilization:

γ-irradiation

Cautions

Storing:

dry, between 5 – 40 °C

Operating Temperature:

5 – 50 °C